

# CERTIFIX RBCS-3.0×6

ISO 15984 Blind Rivet, Countersunk with Grooved Mandrel

SKU: RBCS-4/4-3.0×6

## PRODUCT DESCRIPTION

High-quality fasteners designed for joining thin metal sheets made from durable A4 stainless steel.

## APPLICATIONS

- Ideal for joining thin metal sheets in various industries
- Widely used in automotive, metal construction, locksmithing, and sanitary applications.

## PRODUCT FEATURES

- Flush Finish: The countersunk head ensures a flush appearance.
- Permanent Connection: Prevents accidental disengagement.
- High Strength: The grooved mandrel provides exceptional shear and tensile strength.
- Fast and Efficient: Blind rivets offer a quick and easy installation process.
- A4 construction: Improved durability and corrosion resistance.

## TECHNICAL DATA

|                             |               |
|-----------------------------|---------------|
| Diameter (d):               | 3 mm          |
| Height of head (k):         | 1.3 mm        |
| Sleeve length (l):          | 6 mm          |
| Diameter of head (dk):      | 6.3 mm        |
| Clamping area (Clamp.area): | 1.5-3.0 mm    |
| Materials:                  | A4            |
| EAN/GTIN:                   | 4043377402448 |

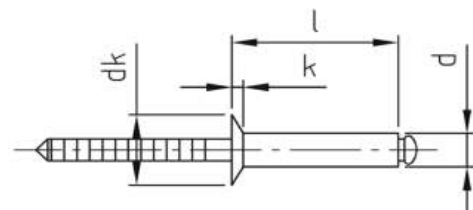

NOTE: The results expressed in this document are determined from empirical testing. Specifiers, end-users and other third parties should make their own decision(s) on what safety factors to use relevant to their design(s)/ application(s). This document is provided, strictly: without prejudice, without recourse, without liability, non-assumptit, no assured value, errors and omissions excepted, subject to change without notice and all rights reserved.  
©Certifix Ltd, 2024